







Priced From
\$364,990

3 Elevations Available

-  **1,516+ Sq. Ft.**
-  **2 Bedrooms**
-  **2.5 Bathrooms**
-  **2 Car Garage**

This plan won't leave you stuck between it and a hard place. Despite the name, Rock is an easy place to live well without an ounce of wasted space. Balanced by two bedrooms and two walk in closets upstairs and a thoughtfully appointed main floor including the largest kitchen in this collection. Rock is proof that good things come in small packages. All that and it still offers a covered porch and a small nook off the kitchen for whatever you need — space for pets, space for an office, it's space that's up to you to decide what's best. Sounds pretty solid, right? Solid as a ...well, you know.



A



B



C

All square footage is approximate. Renderings are artist's conceptions and may vary slightly from the actual home. Homes may be built in reverse of plans shown, depending on site conditions. Minor architectural changes may be made occasionally at the option of the builder. Please contact your Sales Consultant for details.

First Floor

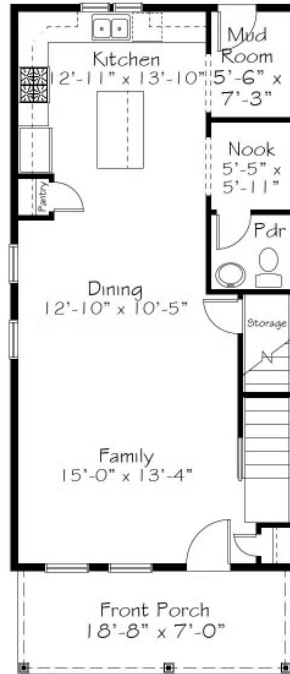

Second Floor

